	Scanning range 4 m
Photoelectric reflex switch	

- With polarisation filter
- Excellent price/performance ratio thanks to an optical ASIC
- Mounting via dovetail
- Can be mounted fast and reliably using a snap holder
- PNP or NPN output
- Sensors stackable

Dimension illustration

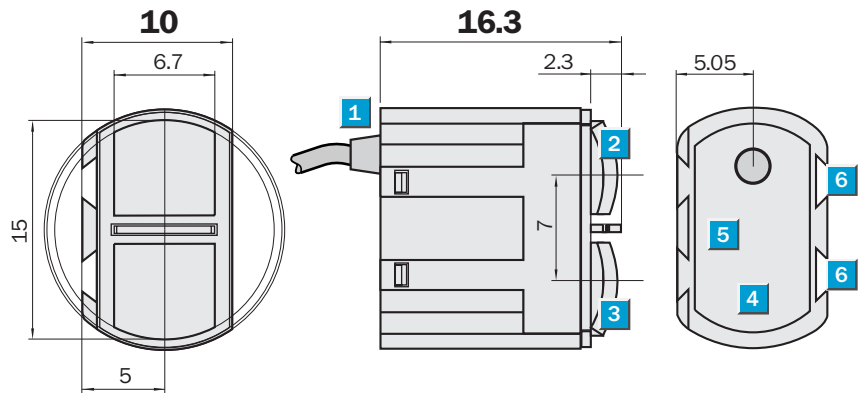

- 1** Connection cable 2 m, 3x 0.25 mm²
- 2** Optic axis sender
- 3** Optic axis receiver
- 4** LED function indicator
- 5** Translucent rear side
- 6** Mounting slots



Connection type

MHL1-P122
MHL1-N122

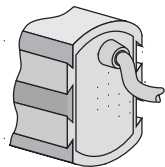

3 x 2.4 mm²

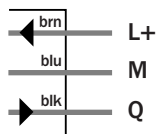

Accessories
Snap holder (included with delivery)
Mini ball joint bracket
Reflectors

Technical data		MHL1-	P122	F122	N122	E122						
Scanning distance typ. max./on reflector	4 m on PL 80 A											
Operating range	2.5 m on PL 80 A											
Light source ¹⁾	LED, red light											
Light spot	80 x 80 mm in 2000 mm											
Supply voltage V_s ²⁾	10 ... 30 VDC											
Ripple ³⁾	< 5 V_{SS}											
Current consumption ⁴⁾	< 20 mA											
Switching outputs	Q_{PNP}											
	Q_{NPN}											
	Light-switching											
	Dark-switching											
Output current I_A max.	50 mA											
Response time	< 2.5 ms											
Switching frequency ⁵⁾	200/s											
Type of connection ⁶⁾	Cable, 2 m											
Enclosure rating	Housing IP 40											
Ambient temperature	Operation	-25 ... +50 °C										
	Storage	-40 ... +70 °C										
Housing material	ABS											

- ¹⁾ Average service life 100,000 h at $T_U = +25$ °C
- ²⁾ Limit values
- ³⁾ Must be within V_s tolerances
- ⁴⁾ Without load
- ⁵⁾ Programmable up to 700/s on request
- ⁶⁾ Do not bend below 0 °C

Scanning distance

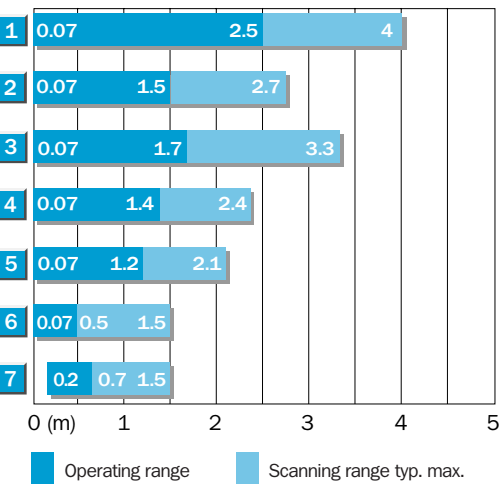

Reflector type	Operating range
1 PL 80 A	0.07 ... 2.5
2 PL 50 A	0.07 ... 1.5
3 P 250	0.07 ... 1.7
4 PL 40 A	0.07 ... 1.4
5 PL 30 A	0.07 ... 1.2
6 PL 20 A	0.07 ... 0.5
7 Diamond grade* reflective tape	0.2 ... 1.5

* Size min. 50 x 50 mm²

Order information

Type	Part no.
MHL1-P122	1 019 709
MHL1-F122	1 019 845
MHL1-N122	1 109 710
MHL1-E122	1 109 846

